

Current Transformers

TI-420-70-Series

WITH 4 to 20 mADC OUTPUT

600 Volt Class

Meet IEC 60044.1, IEC-1010-1, UL94, VDE-0414 Standards

SPECIFICATIONS

INPUT CURRENT RANGE:	100 AAC to 750 AAC
OUTPUT:	4 to 20 mADC
ACCURACY CLASS:	1.5% (from 5% to 110% FS)
MAXIMUM THERMAL CURRENT:	60 Times F.S. for 1 second
MAXIMUM CONTINUOUS CURRENT:	50% Above full scale
MAXIMUM OPERATING VOLTAGE:	700 Volts
ISOLATION TEST:	3 kV - 1 MINUTE
FREQUENCY:	50 - 60 Hz
TEMPERATURE RANGE:	-10 to + 50 Deg. C
STORAGE TEMPERATURE:	-20 to +80 Deg. C
THERMAL INSULATION:	Meets IEC-60044-1
DIMENSIONS:	5.1" x 4.3" x 1.3"
WINDOW SIZE:	2.75"

Applications and Features

FOR INDUSTRIAL APPLICATIONS THAT REQUIRE
4-20 mADC PLC INTERFACING

PROVIDES 4 TO 20 mADC OUTPUT FROM EXTERNAL
POWER SUPPLY of 10 to 24 Volts DC

FIRE RETARDANT POLYCARBONATE CASE
MEETING UL94 STANDARD

SPECIFICATIONS SUBJECT TO CHANGE WITHOUT NOTICE

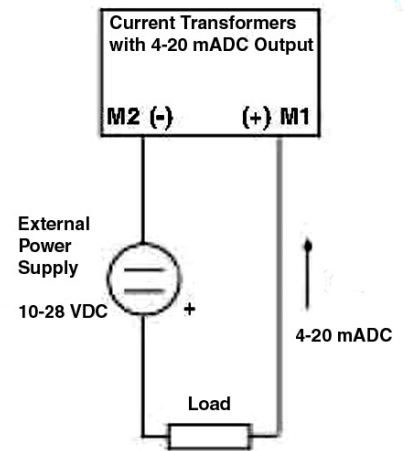
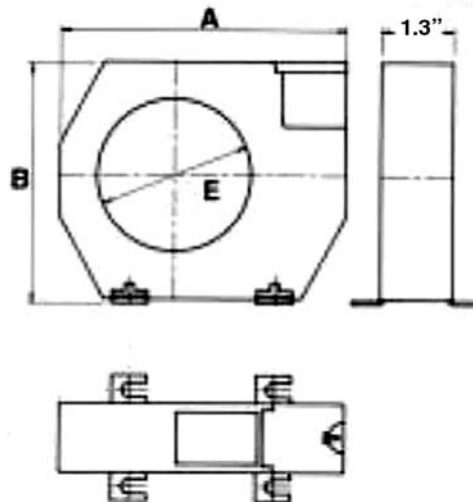

TI-420-70 SELECTION CHART

INPUT	MODEL	WEIGHT
100 AAC	TI-420-70-100	0.83 Lb.
250 AAC	TI-420-70-250	0.83 Lb.
500 AAC	TI-420-70-500	0.83 Lb.
750 AAC	TI-420-70-750	0.83 Lb.

SIZE: 5.1" x 4.3" x 1.3"
CIRCULAR CABLE OPENING: 2.75"

