

Current Transformers

TI-420-35-Series

WITH 4 to 20 mADC OUTPUT

600 Volt Class

Meet IEC 60044.1, IEC-1010-1, UL94, VDE-0414 Standards

SPECIFICATIONS

INPUT CURRENT RANGE:	2.5 AAC to 250 AAC
OUTPUT:	4 to 20 mADC
ACCURACY CLASS:	1.5% (from 5% to 110% FS)
MAXIMUM THERMAL CURRENT:	60 Times F.S. for 1 second
MAXIMUM CONTINUOUS CURRENT:	50% Above full scale
MAXIMUM OPERATING VOLTAGE:	700 Volts
ISOLATION TEST:	3 kV - 1 MINUTE
FREQUENCY:	50 - 60 Hz
TEMPERATURE RANGE:	-10 to + 50 Deg. C
STORAGE TEMPERATURE:	-20 to +80 Deg. C
THERMAL INSULATION:	Meets IEC-60044-1
DIMENSIONS:	3.9" x 3.1" x 1.3"
WINDOW SIZE:	1.38"

Applications and Features

FOR INDUSTRIAL APPLICATIONS THAT REQUIRE 4-20 mADC PLC INTERFACING

PROVIDES 4 TO 20 mADC OUTPUT FROM EXTERNAL POWER SUPPLY of 10 to 24 Volts DC

FIRE RETARDANT POLYCARBONATE CASE MEETING UL94 STANDARD

SPECIFICATIONS SUBJECT TO CHANGE WITHOUT NOTICE

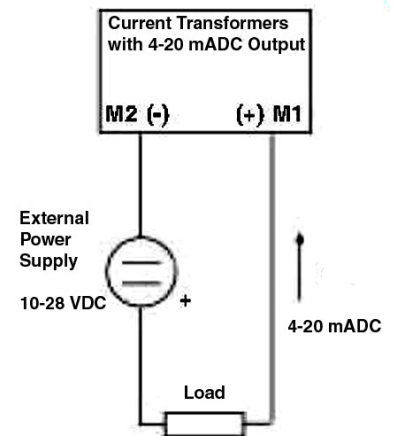
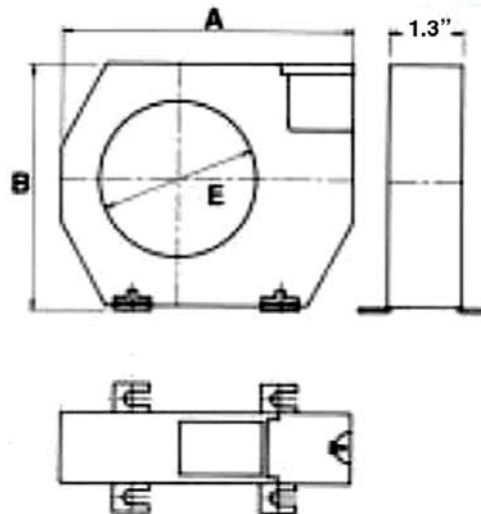

TI-420-35 SELECTION CHART			
INPUT	MODEL		WEIGHT
2.5 AAC	TI-420-35-2.5		0.5 Lb.
5 AAC	TI-420-35-5		0.5 Lb.
10 AAC	TI-420-35-10		0.5 Lb.
20 AAC	TI-420-35-20		0.5 Lb.
50 AAC	TI-420-35-50		0.5 Lb.
100 AAC	TI-420-35-100		0.5 Lb.
250 AAC	TI-420-35-250		0.5 Lb.
SIZE:	3.9" x 3.1" x 1.3"		
CIRCULAR CABLE OPENING:	1.38"		

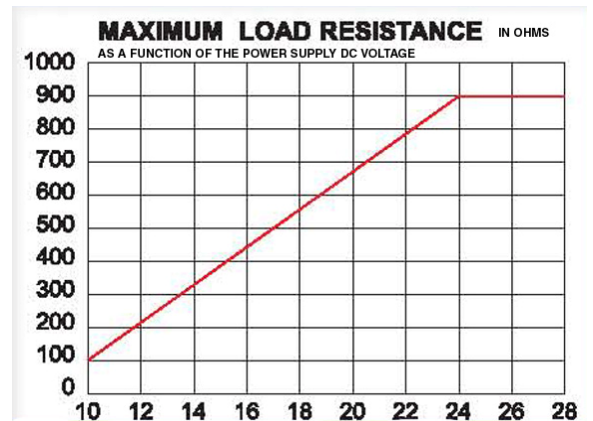

AYA-Instruments, Inc.

5001 Baum Boulevard, Pittsburgh, PA 15213

TEL: 412-622-5500 FAX: 412-681-3773

www.ayainstruments.com