

CURRENT TRANSFORMERS

**Multi Ratio
Model MR22603**



WINDOW SIZE: 2.20"

APPLICATION: For Metering, Wattmeters and Ammeters and Relays

CONTINUOUS THERMAL RATING:
1.33 AT 30C. amb.; 1.0 AT 55 C. amb.

CURRENT RANGE:
50 TO 4000 AAC

INSULATION CLASS:

0.6kV.BIL 10kV. Full wave

50-400 Hz

Fully Encapsulated.

Indoor/outdoor applications

Standard 5-amp secondary.

Others Available

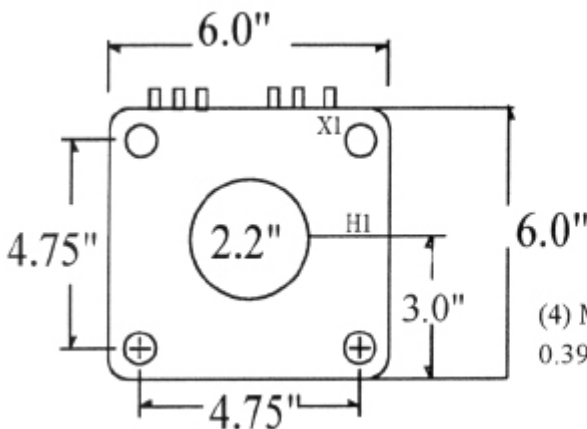

(4) MOUNT HOLES
0.390" DIAMETER.

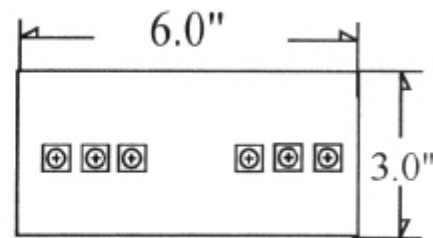

MODEL MR22603-**

- Test winding available, Taps X5 & X6
- Mounting brackets optional. Order No. 22603-MBK
- Additional ratios available
- Approximate weight 16 lbs.
- Made in United States of America

CATALOG NUMBER	CURRENT RATIO	RELAY CLASS	ANSI METERING CLASS AT 60 Hz				
			B0.1	B0.2	B0.5	B0.9	B1.8
**_600	600:5	C50	0.3	0.3	0.3	0.3	0.3
**_1200	1200:5	C100	0.3	0.3	0.3	0.3	0.3
**_2000	2000:5	C100	0.3	0.3	0.3	0.3	0.3
**_3000	3000:5	C50	0.3	0.3	0.3	0.3	0.3
**_4000	4000:5	C50	0.3	0.3	0.3	0.3	0.3
**_500	500:5	C50	0.3	0.3	0.3	0.3	0.6

500:5

600:5

1200:5

2000:5

3000:5

4000:5

CURRENT RATIO	TAP	CURRENT RATIO	TAP	CURRENT RATIO	TAP	CURRENT RATIO	TAP	CURRENT RATIO	TAP	CURRENT RATIO	TAP
50:5	X2-X3	50:5	X2-X3	100:5	X2-X3	300:5	X3-X4	300:5	X3-X4	500:5	X1-X2
100:5	X4-X5	100:5	X1-X2	200:5	X1-X2	400:5	X1-X2	500:5	X4-X5	1000:5	X3-X4
150:5	X1-X2	150:5	X1-X3	300:5	X1-X3	500:5	X4-X5	800:5	X3-X5	1500:5	X2-X3
200:5	X3-X4	200:5	X4-X5	400:5	X4-X5	800:5	X2-X3	1000:5	X1-X2	2000:5	X1-X3
250:5	X2-X4	250:5	X3-X4	500:5	X3-X4	1100:5	X2-X4	1200:5	X2-X3	2500:5	X2-X4
300:5	X3-X5	300:5	X2-X4	600:5	X2-X4	1200:5	X1-X3	1500:5	X2-X4	3000:5	X1-X4
350:5	X2-X5	400:5	X1-X4	800:5	X1-X4	1500:5	X1-X4	2000:5	X2-X5	3500:5	X2-X5
400:5	X1-X4	450:5	X3-X5	900:5	X3-X5	1600:5	X2-X5	2200:5	X1-X3	4000:5	X1-X5
500:5	X1-X5	500:5	X2-X5	1000:5	X2-X5	2000:5	X1-X5	2500:5	X1-X4		
		600:5	X1-X5	1200:5	X1-X5			3000:5	X1-X5		