

**CURRENT TRANSFORMERS**  
**Model 5ASHT, 5ARL, 5ASFT**  
**Window Size: 1.50" to 1.56"**



**APPLICATION:**

With ammeters, wattmeters, and cross current compensation.

**FREQUENCY:**

50-400 Hz.

**INSULATION LEVEL:**

600 Volts, 10 kV BIL full wave.

Flexible leads are UL 1015, 1050C.,  
CSA approved.

#16 AWG, 24. long.

Non-standard length to be specified.

SHT and SHF case styles also available as  
SHL and SFL with leads.

Terminals are brass studs No. 8-32 with one  
flatwasher, lockwasher and regular nut.

Mounting bracket kit 0221B00180 when required  
for Model 5SHT.

Approximate weight 1.0 lbs.

CATALOG NUMBER	CURRENT RATIO	ACCURACY AT 60 Hz	BURDEN VA at 60 Hz
5**-500	50:5	±2%	1.0
5**-750	75:5	±2%	1.5
5**-101	100:5	±2%	2.0
5**-151	150:5	±1%	5.0
5**-201	200:5	±1%	5.0
5**-251	250:5	±1%	10.0
5**-301	300:5	±1%	12.5
5**-401	400:5	±1%	12.5
5**-501	500:5	±1%	20.0
5**-601	600:5	±1%	25.0
* 5**-751	750:5	±1%	25.0
* 5**-801	800:5	±1%	25.0
* 5**-102	1000:5	±1%	25.0
* 5**-122	1200:5	±1%	30.5

\*\*Note: When ordering, prefix Cat No. with model designation required i.e. 5SFT-500, 5RL-500, etc.

\*Note: Available in SFT, SHT and RL only.

Model 5SFT

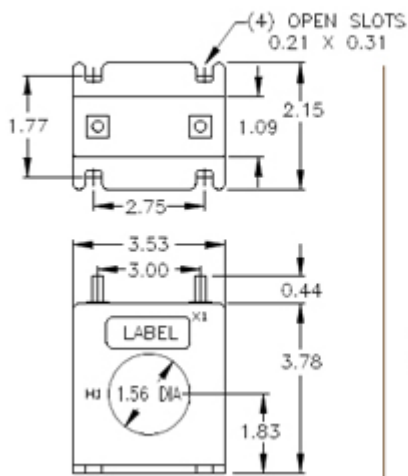

Model 5SHT

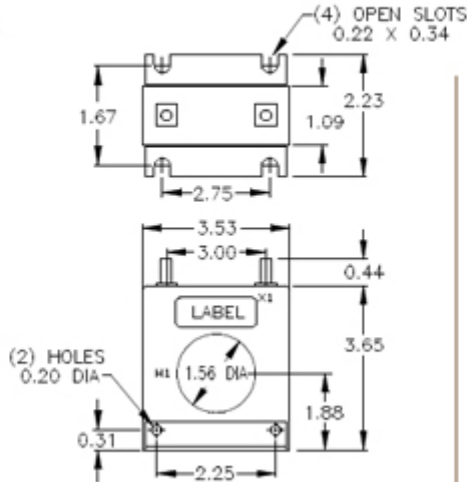

Model 5RT

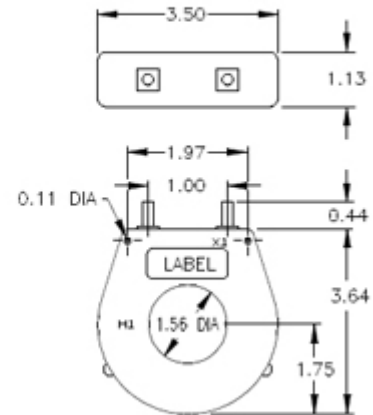

Model 5RBT

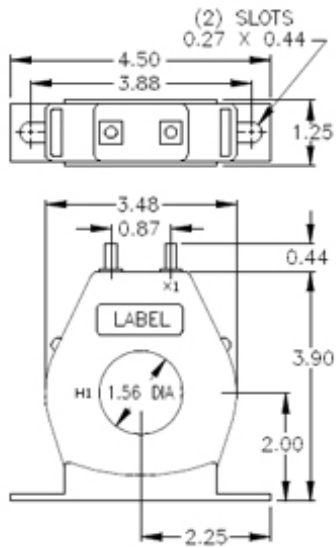

Model 5RL

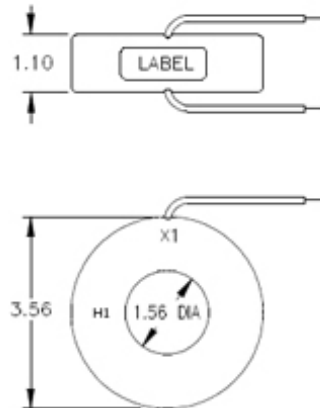

Model 5RBL

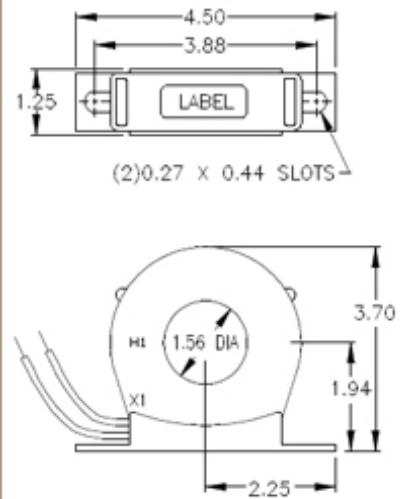

**CURRENT TRANSFORMERS**  
**Models 15352ARW & ARWB**



**WINDOW SIZE: 1.50"**

**APPLICATION:** With Watthour meters, Wattmeters, and Ammeters.

**CONTINUOUS THERMAL RATING:**  
1.33 AT 30C. amb.; 1.0 AT 55 C. amb. Average.

**CURRENT RANGE:**  
50 TO 1200 AAC

**INSULATION CLASS:**

0.6kV.BIL 10kV. Full wave

50-400 Hz

Fully Encapsulated.  
Indoor/outdoor applications

Standard 5-amp secondary.  
Others Available

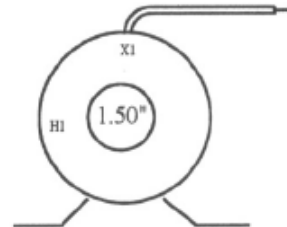
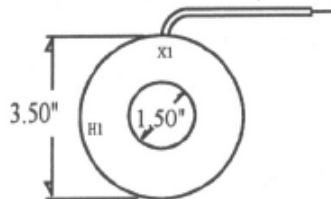
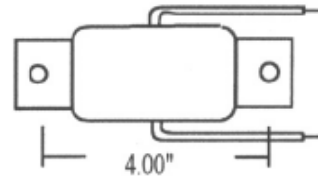
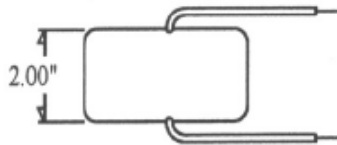

15352ARW-\*\*

15352ARWB-\*\*

- Flexible Leads are UL 3173 125 degree C. CSA approved, #16 AWG 24" long.
- Non-Standard Length to be specified
- Additional ratios available
- Approximate weight 2.5 lbs.
- Made in United States of America

*Similar to ITI models 5DARL*

CATALOG NUMBER	CURRENT RATIO AMPERES	V.A. FOR +-1% CLASS	ANSI METERING CLASS AT 60Hz			
			BO.1	BO.2	BO.5	BO.9
*-100	100:5	5.0	0.6	1.2		
*-150	150:5	10.0	0.6	0.6	0.6	
*-200	200:5	12.5	0.6	0.6	1.2	1.2
*-250	250:5	20.0	0.3	0.3	0.6	1.2
*-300	300:5	25.0	0.3	0.3	0.6	1.2
*-400	400:5	40.0	0.3	0.3	0.6	0.6
*-500	500:5	50.0	0.3	0.3	0.3	0.6
*-600	600:5	60.0	0.3	0.3	0.3	0.3
*-750	750:5	60.0	0.3	0.3	0.3	0.3
*-800	800:5	60.0	0.3	0.3	0.3	0.3
*-1000	1000:5	75.0	0.3	0.3	0.3	0.3
*-1200	1200:5	90.0	0.3	0.3	0.3	0.3